

# GUYED TOWER SURVEY SHEET

Anchor 1:  
Anchor 2:  
Anchor 3:

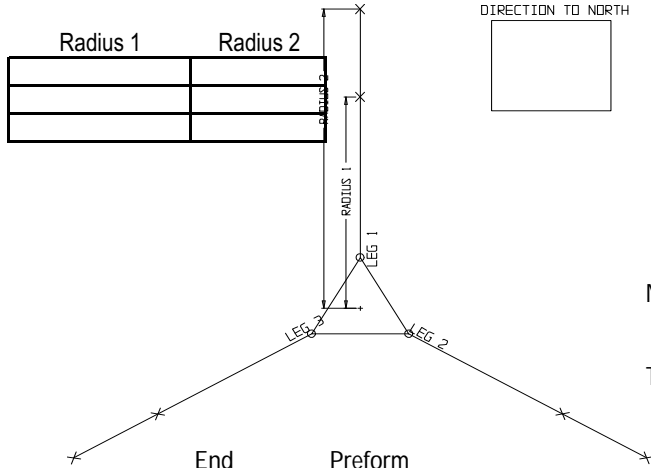

If space is limited, continue on back side of sheet. Sketches must include shape dimensions. (L3x3x3/16, 2-7/8" OD) Sketch and quick dimension antenna mounts on back of sheet.

Number of Guy Cable ELEVATIONS:

Tower Face Dimension: (Inches)

|         | Cable Size<br>(1 @ 1/2"x7") | End Sleeve<br>(65266) | Preform Color<br>(Gr,Blk,Blu) | Turnbuckle<br>(3/4"x12") |
|---------|-----------------------------|-----------------------|-------------------------------|--------------------------|
| Cable 8 |                             |                       |                               |                          |
| Cable 7 |                             |                       |                               |                          |
| Cable 6 |                             |                       |                               |                          |
| Cable 5 |                             |                       |                               |                          |
| Cable 4 |                             |                       |                               |                          |
| Cable 3 |                             |                       |                               |                          |
| Cable 2 |                             |                       |                               |                          |
| Cable 1 |                             |                       |                               |                          |

**SKETCHES W. DIMENSIONS:**

|   |                           |
|---|---------------------------|
| Inner Guy Anchor Head                         | Outer Guy Anchor Head     |
| Torque Arm with dimensions                    | Typical Tower Section     |
| Bottom Tower Section to Foundation connection | Typical Flange Connection |

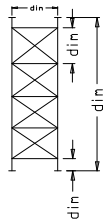

**Camera Pictures:**

- 1: 1 Picture for each span
- 2: Typical Guy pull
- 3: Torque Arm
- 4: Typical Flange Connection
- 5: Typical Brace/Leg Connection

- 6: Typical Section
- 7: Typical GuyHead
- 8: Full Tower
- 9: ID Plater



# TOWER SECTION DATA SHEET

| Section # | Tower Height:<br>Leg Circumference | Leg Thickness          | Diagonals | Horizontals | # of Panels/<br>Type | Section Length | Bottom Face | Bottom Flange Bolts | Bracing Bolts | Diag's V&H Offset |
|-----------|------------------------------------|------------------------|-----------|-------------|----------------------|----------------|-------------|---------------------|---------------|-------------------|
| Ex        | 14-1/8" around<br>(4.5" OD)        | 0.21<br>0.203<br>0.198 | L3x2x3/16 | L1.5xx3/16  | 2<br>1               | 15ft           | 54-1/2"     | (6) 3/4"            | (1) 1/2"      | 1                 |
| 1         |                                    |                        |           |             |                      |                |             |                     |               |                   |
| 2         |                                    |                        |           |             |                      |                |             |                     |               |                   |
| 3         |                                    |                        |           |             |                      |                |             |                     |               |                   |
| 4         |                                    |                        |           |             |                      |                |             |                     |               |                   |
| 5         |                                    |                        |           |             |                      |                |             |                     |               |                   |
| 6         |                                    |                        |           |             |                      |                |             |                     |               |                   |
| 7         |                                    |                        |           |             |                      |                |             |                     |               |                   |
| 8         |                                    |                        |           |             |                      |                |             |                     |               |                   |
| 9         |                                    |                        |           |             |                      |                |             |                     |               |                   |
| 10        |                                    |                        |           |             |                      |                |             |                     |               |                   |
| 11        |                                    |                        |           |             |                      |                |             |                     |               |                   |
| 12        |                                    |                        |           |             |                      |                |             |                     |               |                   |
| 13        |                                    |                        |           |             |                      |                |             |                     |               |                   |
| 14        |                                    |                        |           |             |                      |                |             |                     |               |                   |
| 15        |                                    |                        |           |             |                      |                |             |                     |               |                   |

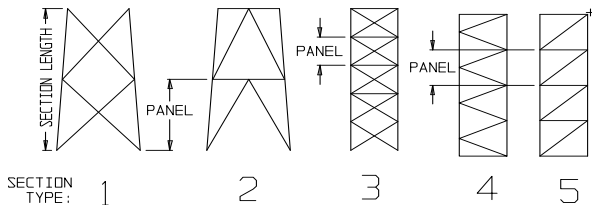

If space is limited, continue on back side of sheet. Sketches must include shape dimensions. (2-7/8" OD, L3x2x3/16)  
 First dim. On angle sees wind!  
 Sketch and quick dimension antenna mounts on back of sheet.

## ANTENNA DATA SHEET

| No. | QTY | Antenna Type | Make/Model | Orientation | Bottom Elevation | Centerline Elevation | Top Elevation | Aximuth | Transmission Line | Antenna Mount (Draw on Back) |
|-----|-----|--------------|------------|-------------|------------------|----------------------|---------------|---------|-------------------|------------------------------|
|     | 3   | Panel        | ASP2895    | Centered    | 236              | 240                  | 244           | 25°     | 1-5/8" Andrew     | 12' Booms                    |
| A   |     |              |            |             |                  |                      |               |         |                   |                              |
| B   |     |              |            |             |                  |                      |               |         |                   |                              |
| C   |     |              |            |             |                  |                      |               |         |                   |                              |
| D   |     |              |            |             |                  |                      |               |         |                   |                              |
| E   |     |              |            |             |                  |                      |               |         |                   |                              |
| F   |     |              |            |             |                  |                      |               |         |                   |                              |
| G   |     |              |            |             |                  |                      |               |         |                   |                              |
| H   |     |              |            |             |                  |                      |               |         |                   |                              |
| I   |     |              |            |             |                  |                      |               |         |                   |                              |
| J   |     |              |            |             |                  |                      |               |         |                   |                              |
| K   |     |              |            |             |                  |                      |               |         |                   |                              |
| L   |     |              |            |             |                  |                      |               |         |                   |                              |
| M   |     |              |            |             |                  |                      |               |         |                   |                              |
| N   |     |              |            |             |                  |                      |               |         |                   |                              |
| O   |     |              |            |             |                  |                      |               |         |                   |                              |
| P   |     |              |            |             |                  |                      |               |         |                   |                              |
| Q   |     |              |            |             |                  |                      |               |         |                   |                              |
| R   |     |              |            |             |                  |                      |               |         |                   |                              |
| S   |     |              |            |             |                  |                      |               |         |                   |                              |
| T   |     |              |            |             |                  |                      |               |         |                   |                              |
| U   |     |              |            |             |                  |                      |               |         |                   |                              |
| V   |     |              |            |             |                  |                      |               |         |                   |                              |
| W   |     |              |            |             |                  |                      |               |         |                   |                              |
| X   |     |              |            |             |                  |                      |               |         |                   |                              |
| Y   |     |              |            |             |                  |                      |               |         |                   |                              |
| Z   |     |              |            |             |                  |                      |               |         |                   |                              |

Antenna Type: **Whip/Omni, Panel, Dipole, Yagi, Dish, GridDish**  
 Orientation: **Upright, Centered, Inverted**  
 NOTE: If antenna model is not known describe antenna (Length Width/Diameter # of Elements Diameter )  
 ELEVATION IS TAPE DROP FROM ANTENNA TO BOTTOM OF TOWER



TRANSMISSION LINE LAYOUT

Indicate  
North

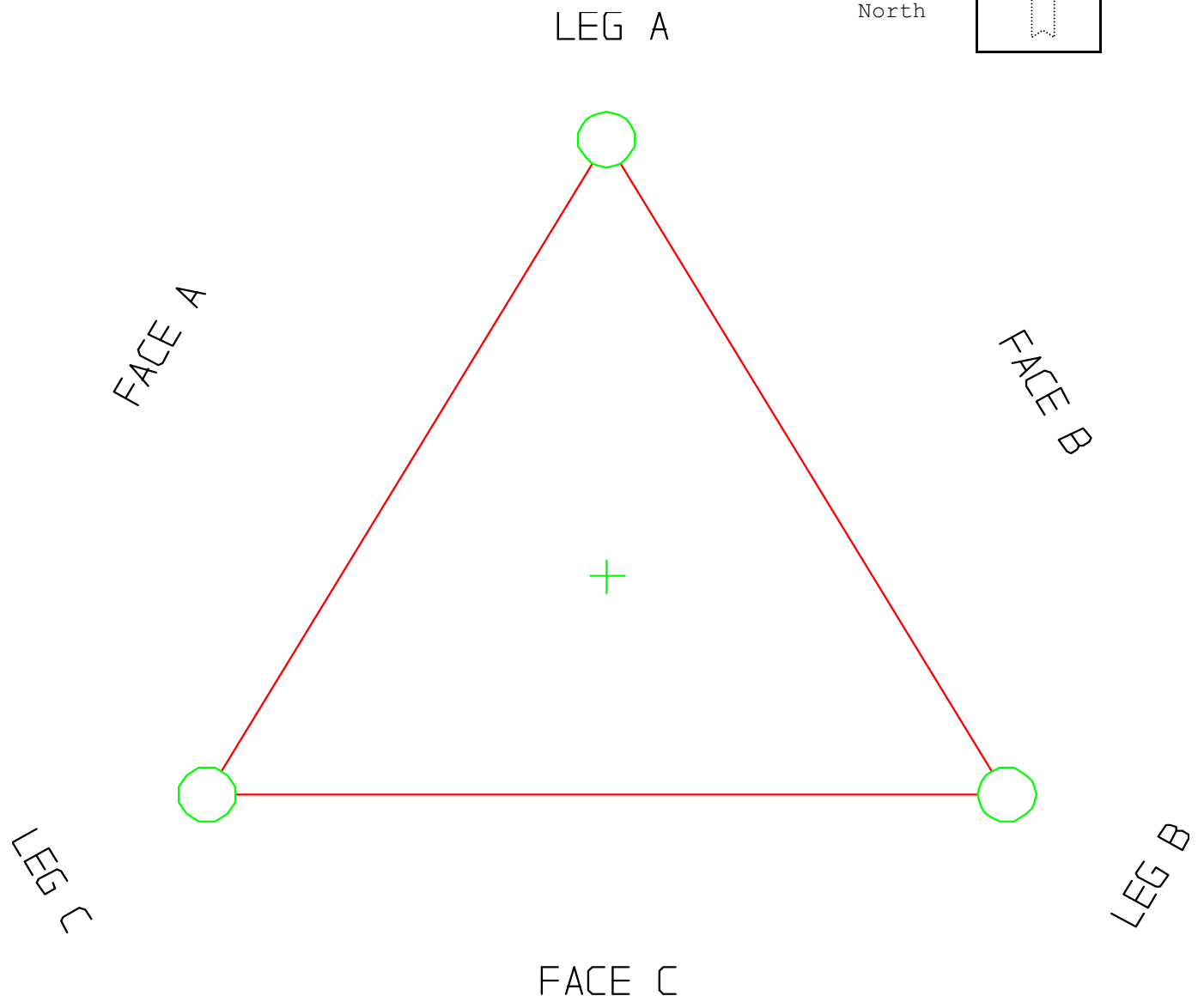

Items to Identify:

- Antenna Feedlines (Stacked, inside/outside of tower)
- Feedline Ladders, Climbing Ladders
- Conduits
- Clusters of Lines
- Carriers associated with the lines/ladders.